

## S. 75-908

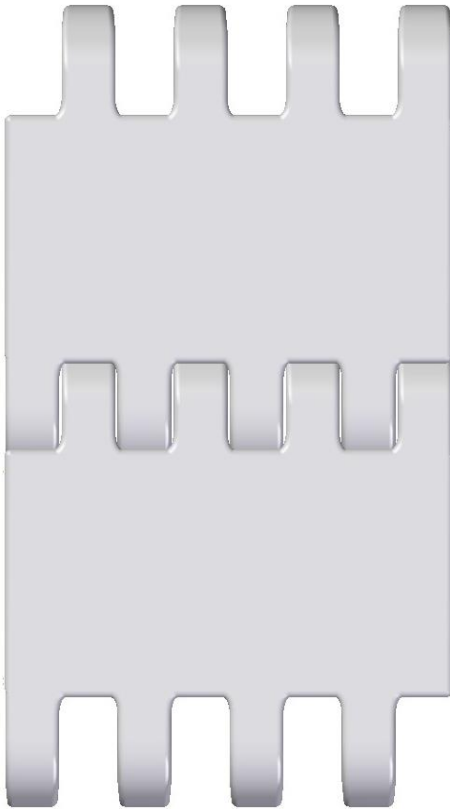

Belt data		
Materials	Max. belt pull kg/m of width	Belt weight kg/m <sup>2</sup>
Polypropylen (PP)	10.000	22
Polyacetal (POM)	16.000	33

**Belt surface:** Closed flat top.  
**Open area:** Closed.  
**Strength:** The right belt for very heavy applications.  
**Material/colour:** PP, POM/black & Yellow.  
**Cleanability:** Good.  
**Accessories:** 50 mm finger flight. Side Guards 40mm.  
**Application:** Very heavy transportation.  
 Assembling belt for cars.  
 Truck loading systems.  
**Standard widths:** Increments of 25 mm, e.g. 100, 125 mm etc

Registered Trademark ®

Sprocket Data								
No. of teeth	A= Outside diameter	B= Pitch-diameter	C= Inside-diameter	Hub width:	Round bore		Square bore	
					mm	in.	mm	in.
upon request	310	280	250	40	mm	in.	mm	in.
12					40/60		60/80/90	

