

PROFILI GUIDA CATENE

CHAINS GUIDE PROFILES

Le guide sono disponibili in versione semplice, doppia o tripla.

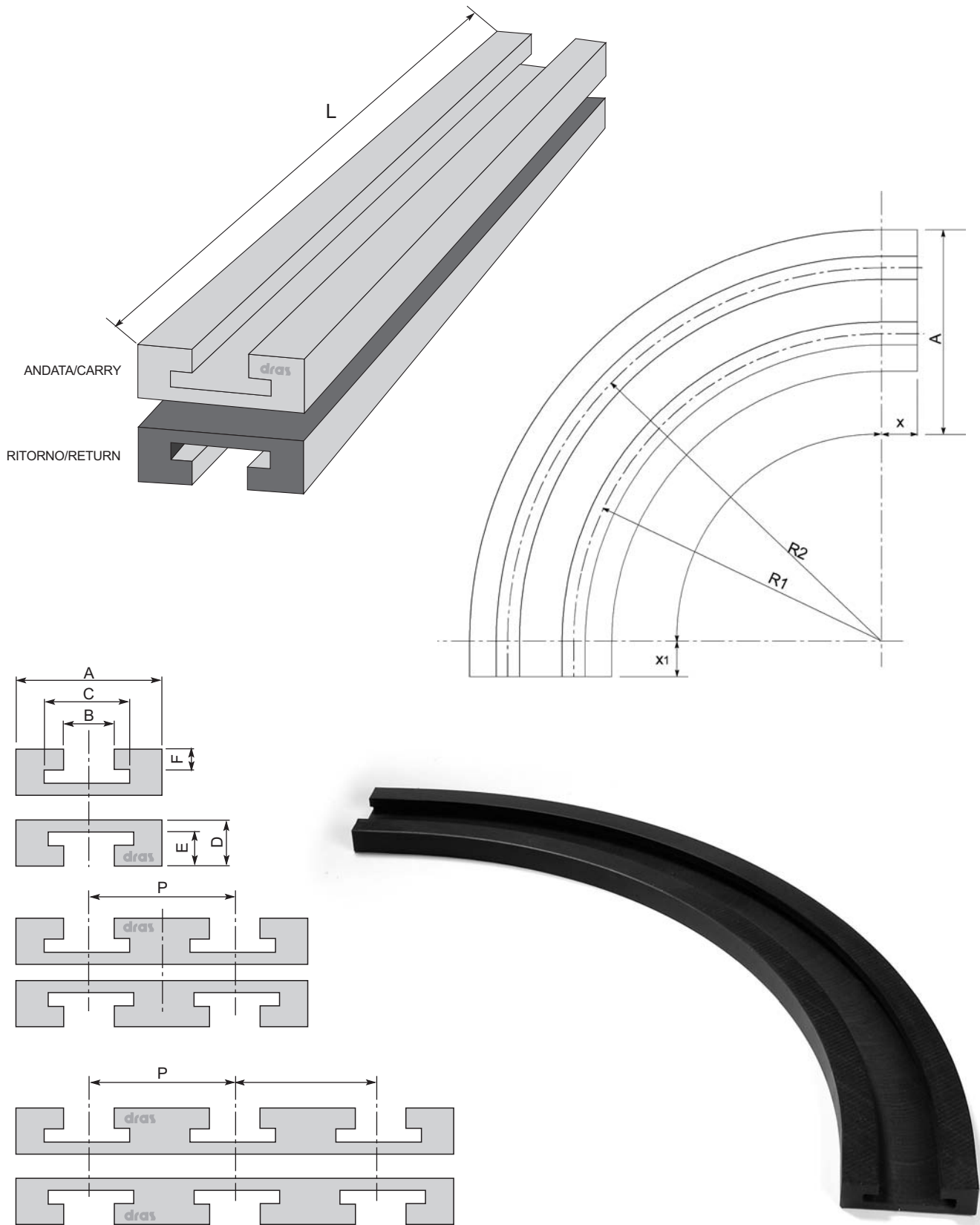

PROFILI GUIDA CATENE - CHAINS GUIDE PROFILES

Realizzate in polietilene ad alto peso molecolare (p.m. oltre 1.000.000). - Colori: nero o verde.
Material high molecular weight polyethylene (m.w. over 1.000.000). - Colour: black or green

Lunghezze standard / Standard length: mt. 2, 3, 4

Peso specifico / Specific weight: 0,94 g/cm³

Coeff. attrito acciaio-polietilene / Friction coefficient steel-polyethylene:
statico / static 0,09 - dinamico / dynamic (a secco / dry) 0,06 (200 gr x 12 cm²)

Dilatazione termico-lineare / Thermic-linear dilatation: 2 mm/M ogni / every 10°
(a partire da una temperatura ambiente di 20° / Starting from an ambient temperature of 20°)

GCS 01 - Profili / Profiles

Per catene semplici - Serie Europea

For simple chains - European serie

COD ISO p A B W H GCS 01/01 (ASA)

| COD | ISO | p | A | B | W | H |
|-------|-------|--------|----|----------|------|-----|
| GCS-1 | 06-B1 | 3/8" | 15 | 10 | 5,4 | 1,5 |
| GCS-2 | 08-B1 | 1/2" | 20 | 10.15.20 | 7,4 | 2,2 |
| GCS-3 | 10-B1 | 5/8" | 20 | 10.15.20 | 9,2 | 2,6 |
| GCS-4 | 12-B1 | 3/4" | 25 | 10.15.20 | 11,3 | 2,4 |
| GCS-5 | 16-B1 | 1" | 40 | 15.20 | 16,5 | 3,5 |
| GCS-6 | 20-B1 | 1" 1/4 | 45 | 15.20 | 19,0 | 4,3 |
| GCS-7 | 24-B1 | 1" 1/2 | 60 | 15.20 | 24,6 | 5,6 |
| GCS-8 | 28-B1 | 1" 3/4 | 75 | 20 | 30,0 | 6,9 |
| GCS-9 | 32-B1 | 2" | 80 | 20 | 30,0 | 7,8 |

p: passo / pitch

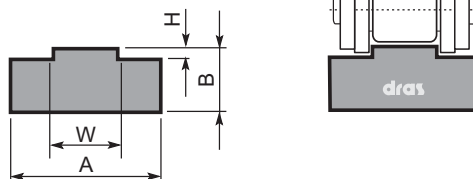

GCD 02 - Profili / Profiles

Per catene doppie - Serie Europea

For double chains - European serie

COD ISO p A B W H M2 GCD 02/02 (ASA)

| COD | ISO | p | A | B | W | H | M2 |
|-------|-------|--------|-----|----------|------|-----|-------|
| GCD-1 | 06-B2 | 3/8" | 25 | 10 | 5,4 | 1,5 | 15,74 |
| GCD-2 | 08-B2 | 1/2" | 35 | 10.15.20 | 7,4 | 2,2 | 21,42 |
| GCD-3 | 10-B2 | 5/8" | 40 | 10.15.20 | 9,2 | 2,6 | 25,79 |
| GCD-4 | 12-B2 | 3/4" | 45 | 15.20 | 11,3 | 2,4 | 30,76 |
| GCD-5 | 16-B2 | 1" | 65 | 15.20 | 16,5 | 3,5 | 48,38 |
| GCD-6 | 20-B2 | 1" 1/4 | 70 | 15.20 | 19,0 | 4,3 | 54,45 |
| GCD-7 | 24-B2 | 1" 1/2 | 88 | 20 | 24,6 | 5,6 | 72,96 |
| GCD-8 | 28-B2 | 1" 3/4 | 105 | 25 | 30,0 | 6,9 | 89,56 |
| GCD-9 | 32-B2 | 2" | 105 | 30 | 30,0 | 7,8 | 88,70 |

p: passo / pitch

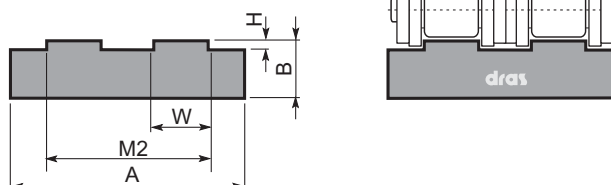

GCT 03 - Profili / Profiles

Per catene triple - Serie Europea

For triple chains - European serie

COD ISO p A B W H M3

| COD | ISO | p | A | B | W | H | M3 |
|-------|-------|------|----|----------|------|-----|-------|
| GCT-1 | 06-B3 | 3/8" | 35 | 10 | 5,4 | 1,5 | 25,88 |
| GCT-2 | 08-B3 | 1/2" | 45 | 10.15.20 | 7,4 | 2,2 | 35,24 |
| GCT-3 | 10-B3 | 5/8" | 55 | 10.15.20 | 9,2 | 2,6 | 42,38 |
| GCT-4 | 12-B3 | 3/4" | 60 | 15.20 | 11,3 | 2,4 | 50,22 |
| GCT-5 | 16-B3 | 1" | 95 | 20 | 16,5 | 3,5 | 80,26 |

p: passo / pitch

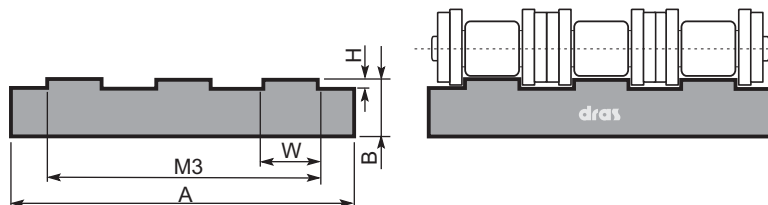

GCDA 01 (ASA) - Profili / Profiles

Per catene semplici - Serie Europea

For simple chains - European serie

COD ISO p A B W H

| COD | ISO | p | A | B | W | H |
|--------|-------|------|----|----------|------|-----|
| GCDA-1 | 06-A1 | 3/8" | 15 | 10 | 4,0 | 2,2 |
| GCDA-2 | 08-A1 | 1/2" | 20 | 10.15.20 | 7,1 | 2,3 |
| GCDA-3 | 10-A1 | 5/8" | 20 | 10.15.20 | 8,6 | 2,7 |
| GCDA-4 | 12-A1 | 3/4" | 25 | 10.15.20 | 11,9 | 3,4 |
| GCDA-5 | 16-A1 | 1" | 40 | 15.20 | 15,1 | 4,5 |

p: passo / pitch

Le misure sono espresse in mm. / Dimensions are expressed in mm.

GCDA 02 (ASA) - Profili / Profiles

Per catene doppie - Serie Europea

For double chains - European serie

COD ISO p A B W H M2

| COD | ISO | p | A | B | W | H | M2 |
|--------|-------|------|----|----------|------|-----|-------|
| GCDA-1 | 06-C2 | 3/8" | 25 | 10 | 4,0 | 2,2 | 14,13 |
| GCDA-2 | 08-A2 | 1/2" | 35 | 10.15.20 | 7,1 | 2,3 | 22,48 |
| GCDA-3 | 10-A2 | 5/8" | 40 | 10.15.20 | 8,6 | 2,7 | 26,71 |
| GCDA-4 | 12-A2 | 3/4" | 45 | 10.15.20 | 11,9 | 3,4 | 34,68 |
| GCDA-5 | 16-A2 | 1" | 55 | 15.20 | 15,1 | 4,5 | 44,39 |

p: passo / pitch

PROFILI GUIDA CATENE - CHAINS GUIDE PROFILES

GCLS 04 - Profili / Profiles

Per catene semplici - Serie Europea*

For simple chains - European serie*

| COD | ISO | p | A | B | W | H | M ₂ | T |
|--------|-------|------|----|----|------|-----|----------------|-------|
| GCLS-1 | 06-B1 | 3/8" | 25 | 10 | 5,4 | 1,5 | 15 | 4,35 |
| GCLS-2 | 08-B1 | 1/2" | 30 | 15 | 7,4 | 2,2 | 20 | 7,17 |
| GCLS-3 | 10-B1 | 5/8" | 33 | 20 | 9,2 | 2,6 | 23 | 9,45 |
| GCLS-4 | 12-B1 | 3/4" | 38 | 20 | 11,3 | 2,4 | 28 | 11,11 |
| GCLS-5 | 16-B1 | 1" | 51 | 25 | 16,5 | 3,5 | 41 | 16,48 |

p: passo / pitch

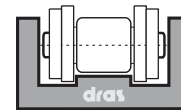
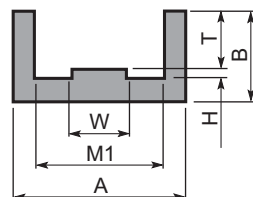

GCLD 05 - Profili / Profiles

Per catene doppie - Serie Europea*

For double chains - European serie*

| COD | ISO | p | A | B | W | H | M ₂ | T |
|--------|-------|------|----|----|------|-----|----------------|-------|
| GCLD-1 | 06-B2 | 3/8" | 36 | 15 | 5,4 | 1,5 | 26 | 4,35 |
| GCLD-2 | 08-B2 | 1/2" | 45 | 20 | 7,4 | 2,2 | 35 | 7,17 |
| GCLD-3 | 10-B2 | 5/8" | 50 | 25 | 9,2 | 2,6 | 40 | 9,45 |
| GCLD-4 | 12-B2 | 3/4" | 56 | 25 | 11,3 | 2,4 | 46 | 11,11 |
| GCLD-5 | 16-B2 | 1" | 85 | 30 | 16,5 | 3,5 | 75 | 16,48 |

p: passo / pitch

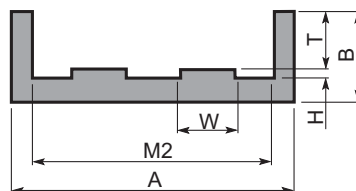

GCV 06 - Profili / Profiles

Per catene a rulli - Serie Europea*

For rollers chain - European serie*

| COD | ISO | p | A | B | C | E | F | H |
|-------|-------|------|----|----|------|---|-----|------|
| GCV-1 | 06-B1 | 3/8" | 20 | 15 | 9,2 | 4 | 2,8 | 4,2 |
| GCV-2 | 08-B1 | 1/2" | 25 | 15 | 12,7 | 5 | 3,5 | 4,8 |
| GCV-3 | 10-B1 | 5/8" | 25 | 15 | 15,2 | 6 | 3,6 | 5,1 |
| GCV-4 | 12-B1 | 3/4" | 25 | 20 | 16,7 | 7 | 3,9 | 5,7 |
| GCV-5 | 16-B1 | 1" | 35 | 25 | 24,4 | 9 | 8,4 | 10,0 |

p: passo / pitch

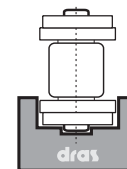
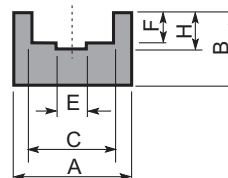

GCVU 07 - Profili / Profiles

Per catene a rulli - Serie Europea*

For rollers chain - European serie*

| COD | ISO | p | A | B | C | D | E | F | G | H |
|--------|-------|-------|----|----|------|------|----|------|------|------|
| GCVU-1 | 06-B1 | 3/8" | 20 | 25 | 9,3 | 6,6 | 4 | 5,6 | 8,7 | 10,0 |
| GCVU-2 | 08-B1 | 1/2" | 24 | 30 | 12,8 | 8,7 | 5 | 7,6 | 11,5 | 13,5 |
| GCVU-3 | 10-B1 | 5/8" | 30 | 35 | 15,4 | 10,4 | 6 | 9,5 | 13,5 | 14,8 |
| GCVU-4 | 12-B1 | 3/4" | 40 | 35 | 16,9 | 12,3 | 7 | 11,5 | 15,9 | 17,5 |
| GCVU-5 | 16-B1 | 1" | 40 | 45 | 24,4 | 16,1 | 9 | 16,1 | 25,7 | 26,8 |
| GCVU-6 | 20-B1 | 1"1/4 | 50 | 50 | 27,5 | 19,3 | 11 | 19,4 | 29,3 | 31,2 |
| GCVU-7 | 24-B1 | 1"1/2 | 60 | 60 | 36,5 | 25,7 | 16 | 25,2 | 38,2 | 40,1 |
| GCVU-8 | 28-B1 | 1"3/4 | 60 | 70 | 41,5 | 28,3 | 17 | 30,8 | 46,9 | 48,9 |
| GCVU-9 | 32-B1 | 2" | 70 | 75 | 44,5 | 29,6 | 19 | 30,8 | 47,3 | 53,0 |

p: passo / pitch

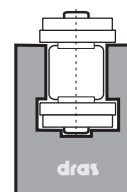
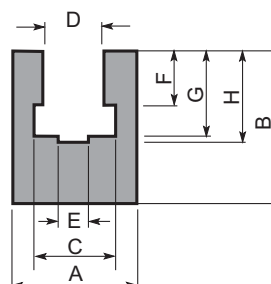

* = disponibile su richiesta anche nella versione Americana (ASA) / Available on request in the American version (ASA)

Le misure sono espresse in mm. / Dimensions are expressed in mm.

PROFILI GUIDA CATENE - CHAINS GUIDE PROFILES

PRT 08 - Profili / Profiles

Per catene semplici - Serie Europea*
For simple chain - European serie*

| COD | ISO | p | A | B | W | H | T | P |
|-------|-------|--------|----|----|------|-----|----|----|
| PRT-1 | 06-B1 | 3/8" | 20 | 15 | 5,4 | 1,5 | 17 | C3 |
| PRT-2 | 08-B1 | 1/2" | 20 | 15 | 7,4 | 2,2 | 17 | C3 |
| PRT-3 | 10-B1 | 5/8" | 20 | 15 | 9,2 | 2,6 | 17 | C3 |
| PRT-4 | 12-B1 | 3/4" | 20 | 15 | 11,3 | 2,4 | 17 | C3 |
| PRT-5 | 16-B1 | 1" | 28 | 15 | 16,5 | 3,5 | 18 | C5 |
| PRT-6 | 20-B1 | 1" 1/4 | 38 | 20 | 19,0 | 4,3 | 27 | C9 |

p: passo / pitch

P: Profilo metallico/ Metallic Profile

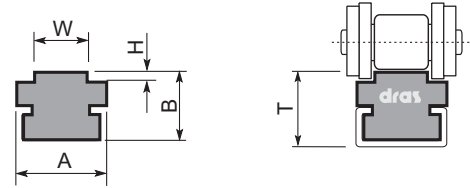

PRTD 09 - Profili / Profiles

Per catena doppia - Serie Europea*
For double chain - European serie*

| COD | ISO | p | A | B | W | H | T | P |
|--------|-------|------|------|----|------|-----|----|----|
| PRTD-1 | 06-B2 | 3/8" | 15,7 | 15 | 5,4 | 1,5 | 17 | C3 |
| PRTD-2 | 08-B2 | 1/2" | 21,4 | 15 | 7,4 | 2,2 | 17 | C3 |
| PRTD-3 | 10-B2 | 5/8" | 25,9 | 15 | 9,2 | 2,6 | 19 | C5 |
| PRTD-4 | 12-B2 | 3/4" | 30,7 | 15 | 11,3 | 2,4 | 19 | C5 |
| PRTD-5 | 16-B2 | 1" | 48,3 | 20 | 16,5 | 3,5 | 27 | C9 |

p: passo / pitch

P: Profilo metallico/ Metallic Profile

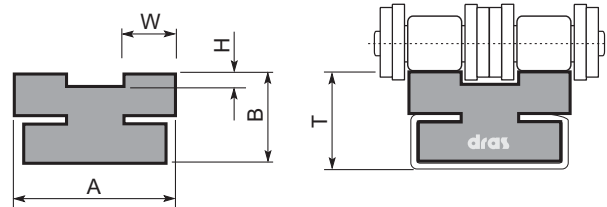

PRP 10 - Profilo per catena / Profiles for chain

Semplice e doppia / Simple and double

| COD | A | B | H | T | P |
|-------|----|----|----|----|----|
| PRP-1 | 20 | 10 | 4 | 14 | C3 |
| PRP-2 | 20 | 15 | 7 | 17 | C3 |
| PRP-3 | 20 | 20 | 12 | 22 | C3 |
| PRP-4 | 28 | 10 | 3 | 15 | C5 |
| PRP-5 | 28 | 15 | 6 | 18 | C5 |
| PRP-6 | 28 | 20 | 12 | 24 | C5 |
| PRP-7 | 38 | 10 | 3 | 21 | C9 |
| PRP-8 | 38 | 15 | 6 | 24 | C9 |
| PRP-9 | 38 | 20 | 12 | 30 | C9 |

P: Profilo metallico/ Metallic Profile

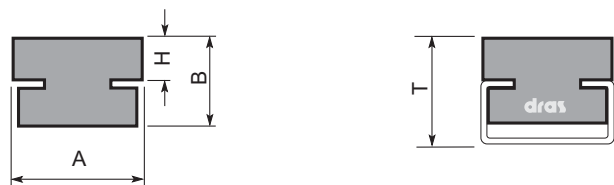

PRVU 12 - Profili / Profiles

Per catene semplici - Serie Europea*
For simple chain - European serie*

| COD | ISO | p | A1 | T | W | D | B | A | P |
|-----------|-------|--------|----|----|------|------|------|------|-----|
| PRVU-12-1 | 06-B1 | 3/8" | 30 | 24 | 5,6 | 6,6 | 22,5 | 26,7 | C10 |
| PRVU-12-2 | 08-B1 | 1/2" | 30 | 24 | 7,6 | 8,7 | 22,5 | 26,7 | C10 |
| PRVU-12-3 | 10-B1 | 5/8" | 30 | 24 | 9,5 | 10,4 | 22,5 | 26,7 | C10 |
| PRVU-12-4 | 12-B1 | 3/4" | 30 | 24 | 11,5 | 12,3 | 22,5 | 26,7 | C10 |
| PRVU-12-5 | 16-B1 | 1" | 45 | 40 | 16,1 | 16,1 | 38,5 | 40,2 | C11 |
| PRVU-12-6 | 20-B1 | 1" 1/4 | 45 | 40 | 19,5 | 19,3 | 38,5 | 40,2 | C11 |

p: passo / pitch

P: Profilo metallico/ Metallic Profile

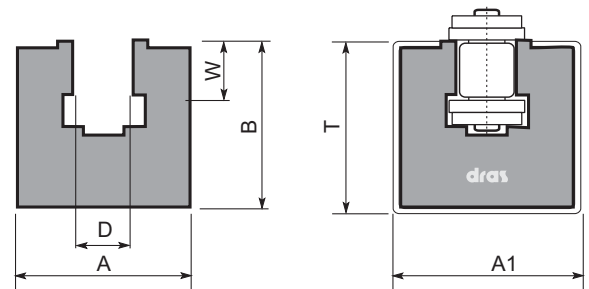

*: disponibile su richiesta anche nella versione Americana (ASA) / Available on request in the American version (ASA).

Le misure sono espresse in mm. / Dimensions are expressed in mm.

PROFILI GUIDA CATENE - CHAINS GUIDE PROFILES

PROH 13 - Profili / Profiles

Per catene semplici - Serie Europea*
For simple chain - European serie*

| COD | ISO | p | A | B | W | D | T | P |
|--------|-------|------|------|------|------|------|------|----|
| PROH-1 | 06-B1 | 3/8" | 20 | 26,4 | 5,4 | 6,6 | 28,7 | C3 |
| PROH-2 | 08-B1 | 1/2" | 20 | 28 | 7,6 | 8,7 | 30,5 | C3 |
| PROH-3 | 10-B1 | 5/8" | 20 | 34,1 | 9,5 | 10,4 | 36 | C3 |
| PROH-4 | 12-B1 | 3/4" | 24 | 38,5 | 11,5 | 12,3 | 41,5 | C5 |
| PROH-5 | 16-B1 | 1" | 33,5 | 52,4 | 16,9 | 16,1 | 61,5 | C9 |

p: passo / pitch

P: Profilo metallico/ Metallic Profile

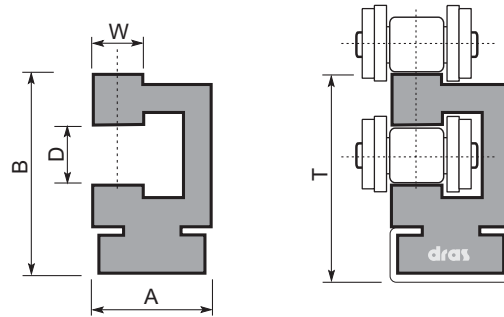

PRV 14 - Profilo per catena verticale a rulli / Profiles for chain

Per catene semplici - Serie Europea*
For simple chain - European serie*

| COD | ISO | p | A | B | C | E | F | H | T | P |
|-------|-------|------|----|----|------|---|-----|------|----|----|
| PRV-1 | 06-B1 | 3/8" | 20 | 10 | 9,2 | 4 | 2,8 | 4,2 | 16 | C3 |
| PRV-2 | 08-B1 | 1/2" | 20 | 15 | 12,7 | 5 | 3,5 | 4,8 | 18 | C1 |
| PRV-3 | 10-B1 | 5/8" | 23 | 15 | 15,2 | 6 | 3,6 | 5,1 | 18 | C3 |
| PRV-4 | 12-B1 | 3/4" | 23 | 20 | 16,7 | 7 | 3,9 | 5,7 | 23 | C3 |
| PRV-5 | 16-B1 | 1" | 32 | 25 | 24,4 | 9 | 8,4 | 10,0 | 28 | C5 |

p: passo / pitch

P: Profilo metallico/ Metallic Profile

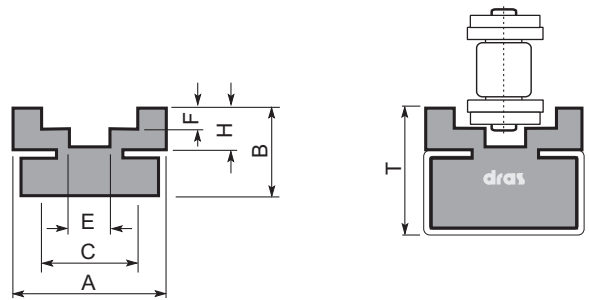

PRVU 15 - Profili / Profiles

Per catene semplici - Serie Europea*
For simple chain - European serie*

| COD | ISO | p | A | B | C | D | E | F | G | H | T | P |
|----------|-------|------|----|------|------|------|----|------|------|------|----|----|
| PRVU15-1 | 06-B1 | 3/8" | 20 | 17,5 | 9,3 | 6,6 | 4 | 5,6 | 8,7 | 9,9 | 21 | C3 |
| PRVU15-2 | 08-B1 | 1/2" | 24 | 27,5 | 12,8 | 8,7 | 5 | 7,6 | 11,5 | 12,7 | 32 | C5 |
| PRVU15-3 | 10-B1 | 5/8" | 24 | 27,5 | 15,4 | 10,4 | 6 | 9,5 | 13,5 | 14,8 | 32 | C5 |
| PRVU15-4 | 12-B1 | 3/4" | 33 | 34 | 16,9 | 12,3 | 7 | 11,5 | 15,9 | 17,5 | 43 | C9 |
| PRVU15-5 | 16-B1 | 1" | 38 | 40 | 24,4 | 16,1 | 9 | 16,9 | 25,7 | 26,8 | 50 | C9 |
| PRVU15-6 | 20-B1 | 1/4" | 44 | 50 | 27,5 | 19,3 | 11 | 19,4 | 29,3 | 31,2 | 54 | C9 |

p: passo / pitch

P: Profilo metallico/ Metallic Profile

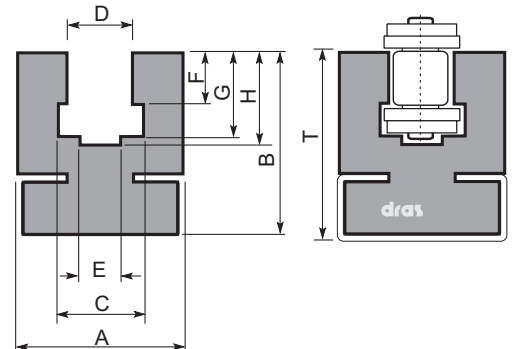

*: disponibile su richiesta anche nella versione Americana (ASA); Available on request in the American version (ASA)
Le misure sono espresse in mm. / Dimensions are expressed in mm.

Profili per cinghie tonde / profiles for chains

| COD | A | B1/B2 | H | d. gola | Ø cinghia | A1 | T | P |
|------|----|-------|-----|---------|-----------|----|----|----|
| | mm | mm | mm | mm | mm | mm | mm | |
| R-01 | 15 | 10 | 2 | 4 | 4 | 20 | 14 | C3 |
| R-03 | 15 | 10 | 2,5 | 5 | 5 | 20 | 14 | C3 |
| R-05 | 20 | 10 | 3 | 6 | 6 | 20 | 14 | C3 |
| R-07 | 20 | 10 | 4 | 8 | 8 | 20 | 14 | C3 |
| R-09 | 25 | 15/12 | 5 | 10 | 10 | 25 | 18 | C5 |
| R-11 | 25 | 15/12 | 6 | 12 | 12 | 25 | 18 | C5 |
| R-13 | 25 | 15 | 7,5 | 15 | 15 | 25 | 18 | C5 |
| R-15 | 30 | 20 | 10 | 20 | 20 | 28 | 24 | C5 |

p: passo / pitch

P: Profilo metallico/ Metallic Profile

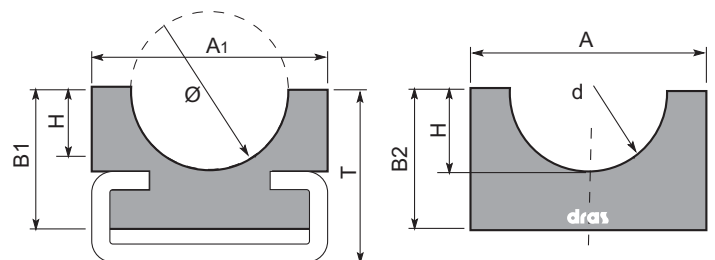

PROFILI TIPO "V" - V SHAPED PROFILES

| COD | A mm | B1 mm | b mm | H mm | A1 cing. mm | Tipo cinghia | T mm |
|------|------|-------|------|------|-------------|--------------|------|
| V-01 | 20 | 10 | 6,5 | 3 | 10 | Sez. Z | 17 |
| V-03 | 20 | 12 | 8 | 5 | 13 | Sez. A | 17 |
| V-05 | 25 | 12 | 9,5 | 5 | 15 | Sez. SPB | 24 |
| V-07 | 30 | 15 | 10,5 | 8 | 17 | Sez. B | 24 |
| V-09 | 35 | 20 | 13,5 | 11 | 22 | Sez. C | 32 |
| V-11 | 40 | 25 | 19 | 13 | 30 | Sez.D | 35 |

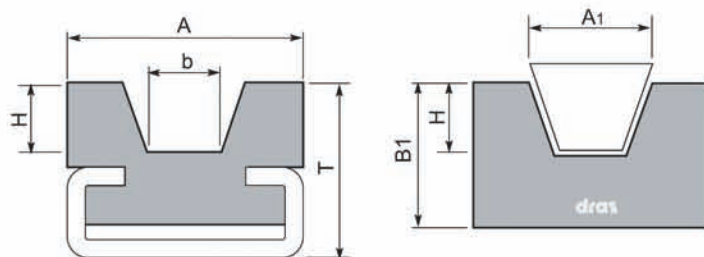

Durante la fase di progettazione, se si devono impiegare delle guide per cinghie trapezoidali, è opportuno sapere che:

- per svolgere la funzione di trasporto la cinghia deve sporgere dalla superficie della guida
- qualora la cinghia fosse attaccata ad un nastro per trasporto per fungere da guida, dovremmo calcolare la profondità della gola in maniera tale da consentire il perfetto appoggio della superficie inferiore del nastro sul piano superiore della guida.

Le nostre guide hanno una profondità (H) calcolata per far sporgere la cinghia di 3 mm dalla guida.

Guide con la quota (H) diversa dallo standard sono fornibili su richiesta.

PROFILO METALLICO PER CATENA VERTICALE A RULLI (rif. ISO) METALLIC PROFILE

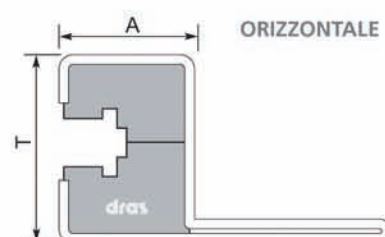
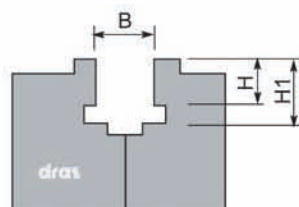
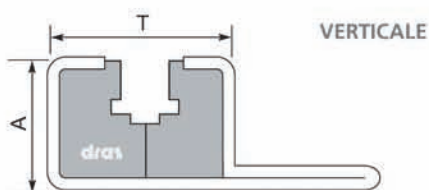

| COD | Tipo di catena | Riferim. ISO | T mm | A mm | B mm | H mm | H1 mm | Prof. met. di fiss. | |
|--------|----------------|--------------|------|------|------|------|-------|---------------------|-------|
| | | | | | | | | Orizz. | Vert. |
| BKC-01 | 3/8" | 06-B1 | 31 | 25 | 6,6 | 5,6 | 8,7 | C-14 | C-15 |
| BKC-05 | 1/2" | 08-B1 | 31 | 25 | 8,7 | 7,6 | 11,5 | C-14 | C-15 |
| BKC-09 | 5/8" | 10-B1 | 31 | 25 | 10,4 | 9,5 | 13,5 | C-14 | C-15 |
| BKC-15 | 3/4" | 12-B1 | 31 | 25 | 12,3 | 11 | 15,9 | C-14 | C-15 |

L'articolo non comprende il profilo metallico / Without metallic profile

PROFILI METALLICI / METALLIC PROFILE

Dilatazione termica

il profilo ha un coefficiente di dilatazione termica abbastanza grande.

I profili a "C" consentono di assorbire le eventuali variazioni di temperatura.

| COD | Materiale | Peso kg/m | T mm | A mm | b mm | s mm |
|---------|--------------|-----------|------|------|------|------|
| * C-1 | Acc. Zincato | 0,28 | 24 | 5,2 | 17,5 | 1 |
| C-3 | Acc. Zincato | 0,43 | 20 | 10 | 10 | 1,3 |
| C-5 | Acc. Zincato | 0,85 | 28 | 12 | 14 | 1,8 |
| C-9 | Acc. Zincato | 0,98 | 38 | 18 | 22 | 1,5 |
| C-10 | Acc. Zincato | 0,94 | 30 | 24 | 20 | 1,5 |
| C-11 | Acc. Zincato | 2,05 | 45 | 40 | 31 | 1,5 |
| C-14 | Acc. Zincato | 1,2 | 31 | 25 | 20 | 2 |
| C-15 | Acc. Zincato | 1,2 | 31 | 25 | 20 | 2 |
| CI-3 | Acc. Inox | 0,43 | 20 | 10 | 10 | 1,3 |
| CI-5 | Acc. Inox | 0,85 | 28 | 12 | 14 | 1,8 |
| CI-9 | Acc. Inox | 0,98 | 38 | 18 | 22 | 1,5 |
| CI-10 | Acc. Inox | 0,94 | 30 | 24 | 20 | 1,5 |
| CI-11 | Acc. Inox | 2,05 | 45 | 40 | 31 | 1,5 |
| * CI-14 | Acc. Inox | 1,2 | 31 | 25 | 20 | 2 |
| * CI-15 | Acc. Inox | 1,2 | 31 | 25 | 20 | 2 |

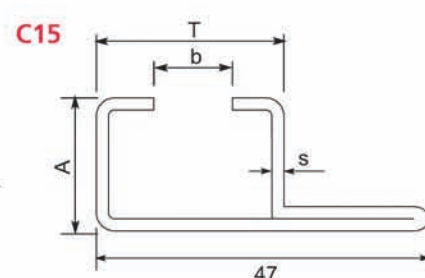
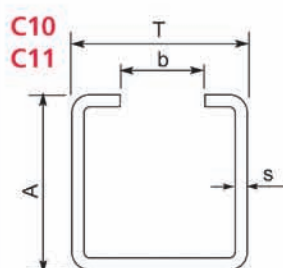
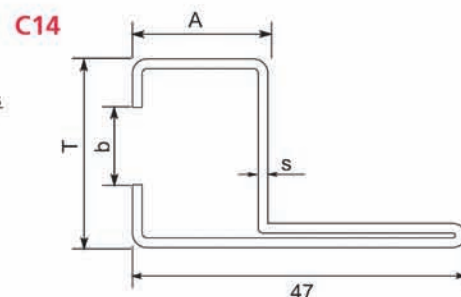
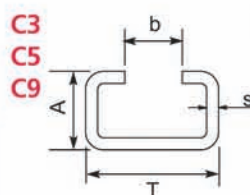

*: Non disponibile a magazzino. Solo su richiesta.